

# PH Series: INLINE — Flange Output

## PH Standard Input

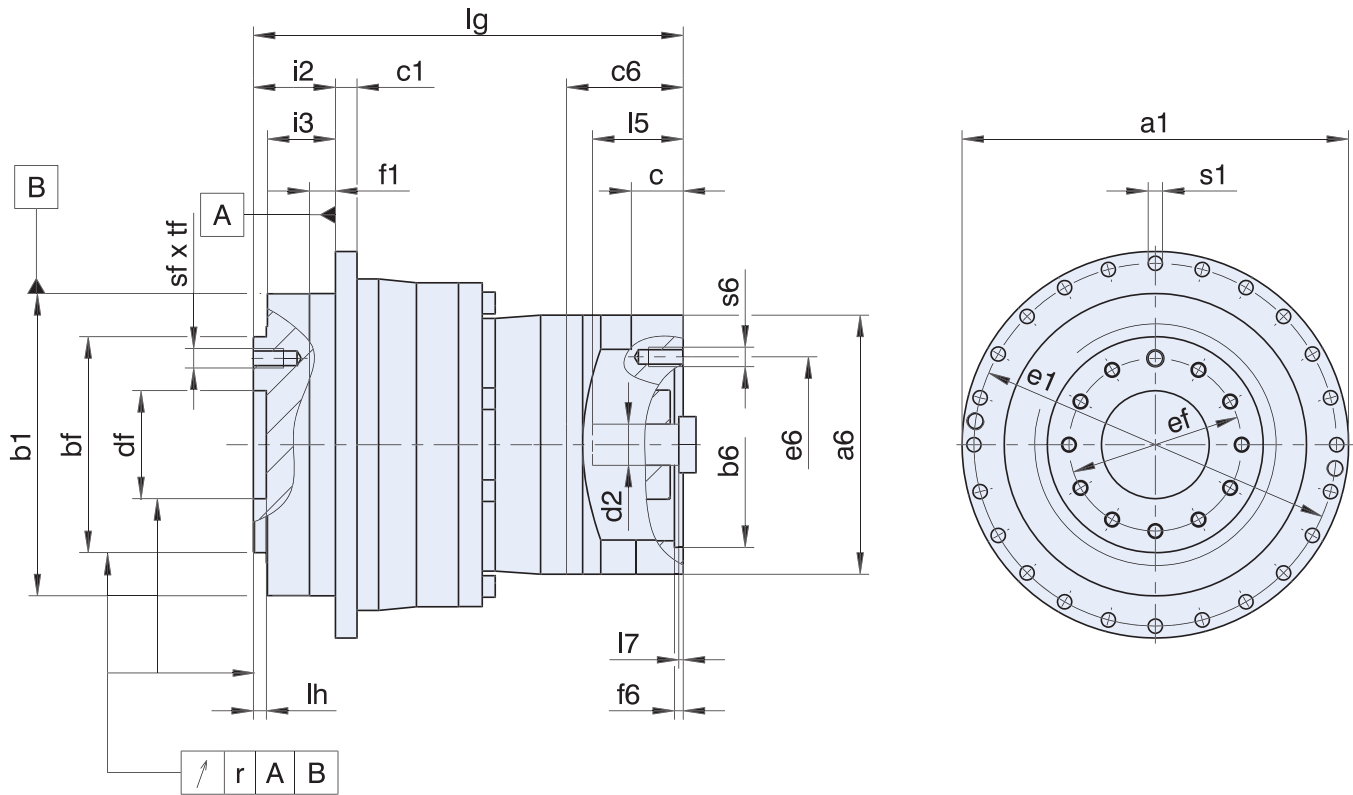

PH3 | PH4

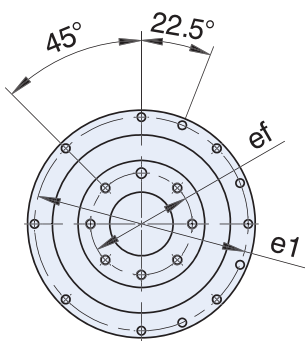

PH5

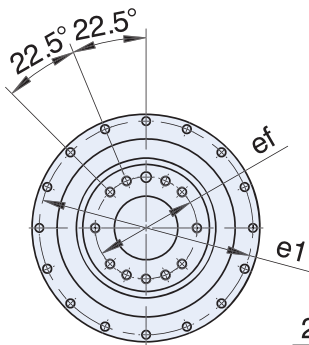

PH7 | PH8

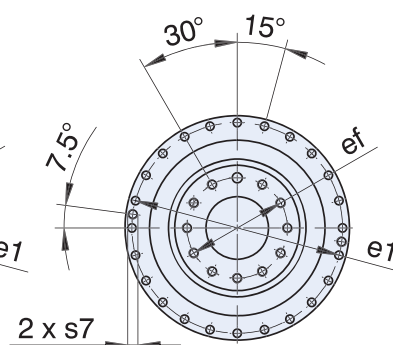

PH9 | PH10

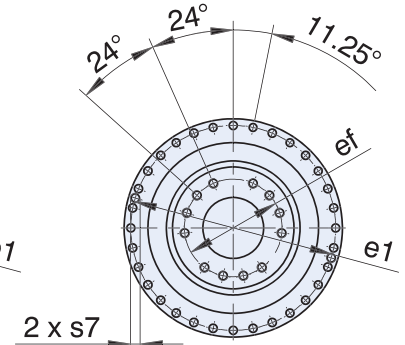

\* See Motor Mounting Plate Option, page 32 for details.



# Dimensional Data

**Table 1 Dimensions (mm)**

Unit	Øa1	Øb1	Øbf	c1	Ødf	Øe1	Øef	f1	i2	i3	lh	r	Øs1	s7	sf	tf
PH331	86	64 <sup>h7</sup>	40 <sup>h7</sup>	4	20.0 <sup>H6</sup>	79	31.5	7	19.5	16.5	4	0.020	4.5	–	M5	7
PH332	86	64 <sup>h7</sup>	40 <sup>h7</sup>	4	20.0 <sup>H6</sup>	79	31.5	7	19.5	16.5	4	0.020	4.5	–	M5	7
PH431	118	90 <sup>h7</sup>	63 <sup>h7</sup>	7	31.5 <sup>H6</sup>	109	50.0	10	30.0	24.0	6	0.020	5.5	–	M6	11
PH432	118	90 <sup>h7</sup>	63 <sup>h7</sup>	7	31.5 <sup>H6</sup>	109	50.0	10	30.0	24.0	6	0.020	5.5	–	M6	11
PH531	145	110 <sup>h7</sup>	80 <sup>h7</sup>	8	40.0 <sup>H6</sup>	135	63.0	12	29.0	23.0	6	0.020	5.5	–	M6	11
PH532	145	110 <sup>h7</sup>	80 <sup>h7</sup>	8	40.0 <sup>H6</sup>	135	63.0	12	29.0	23.0	6	0.020	5.5	–	M6	11
PH731	179	140 <sup>h7</sup>	100 <sup>h7</sup>	10	50.0 <sup>H6</sup>	168	80.0	12	38.0	32.0	6	0.025	6.6	–	M8	14
PH732	179	140 <sup>h7</sup>	100 <sup>h7</sup>	10	50.0 <sup>H6</sup>	168	80.0	12	38.0	32.0	6	0.025	6.6	–	M8	14
PH831	247	200 <sup>h7</sup>	160 <sup>h7</sup>	12	80.0 <sup>H6</sup>	233	125.0	15	50.0	42.0	8	0.030	9.0	M10	M10	18
PH832	247	200 <sup>h7</sup>	160 <sup>h7</sup>	12	80.0 <sup>H6</sup>	233	125.0	15	50.0	42.0	8	0.030	9.0	M10	M10	18
PH942	300	255 <sup>h7</sup>	180 <sup>h7</sup>	18	90.0 <sup>H6</sup>	280	140.0	20	66.0	55.0	12	0.030	13.5	M8	M16	24
PHV943	300	255 <sup>h7</sup>	180 <sup>h7</sup>	18	90.0 <sup>H6</sup>	280	140.0	20	66.0	55.0	12	0.030	13.5	M8	M16	24
PH1042	330	285 <sup>h7</sup>	200 <sup>h7</sup>	20	95.0 <sup>H6</sup>	310	160.0	20	75.0	60.0	10	0.040	13.5	M10	M20	28
PHV1043	330	285 <sup>h7</sup>	200 <sup>h7</sup>	20	95.0 <sup>H6</sup>	310	160.0	20	75.0	60.0	10	0.040	13.5	M10	M20	28

**Table 2 Dimensions (mm)**

Unit	Øb6	Øe6	Ød2max	l5	□a6	c	c6	f6	l7	lg	s6
PH331_ME	60 <sup>H7</sup>	75	19	41	75	18	41.5	3.5	4.0	98.5	M5
PH332_ME	40 <sup>H7</sup>	63	14	30	55	15	32.0	3.5	3.0	116.0	M5
PH431_ME	95 <sup>H7</sup>	115	24	41	100	21	42.5	4.0	3.5	113.5	M8
PH432_ME	60 <sup>H7</sup>	75	19	41	75	18	41.5	3.5	4.0	150.5	M5
PH531_ME	110 <sup>H7</sup>	130	32	51	120	24	54.0	4.0	4.5	132.0	M8
PH532_ME	95 <sup>H7</sup>	115	24	41	100	21	42.5	4.0	3.5	161.0	M8
PH731_ME	130 <sup>H7</sup>	165	38	61	150	26	66.0	5.5	4.5	161.0	M10
PH732_ME	110 <sup>H7</sup>	130	32	51	120	24	54.0	4.0	4.5	199.0	M8
PH831_ME	180 <sup>H7</sup>	215	48	83	204	35	80.5	5.5	8.5	218.0	M12
PH832_ME	130 <sup>H7</sup>	165	38	61	150	26	66.0	5.5	4.5	263.0	M10
PH942_ME	180 <sup>H7</sup>	215	48	83	204	35	80.5	5.5	8.5	334.5	M12
PHV943_ME	130 <sup>H7</sup>	165	38	61	150	26	66.0	5.5	4.5	294.0	M10
PH1042_ME	180 <sup>H7</sup>	215	48	83	204	35	80.5	5.5	8.5	350.5	M12
PHV1043_ME	180 <sup>H7</sup>	215	48	83	204	35	80.5	5.5	8.5	344.0	M12

In the table above, you will find example dimensions for the motor connection for the ME motor adapter. Note that when dimension c is lengthened (depending on the motor used), dimensions c6, l5 and lg are also lengthened accordingly. You will find additional motor connection dimensions for motor adapters ME, MEL, MF and MFL in our STÖBER Configurator at <http://configurator.stober.com>. Here, you can directly download a 3D model of your drive.

PH Series: INLINE — Flange Output